

# PRRAY FAB

## INDUSTRIES

*You Can Think It, we Can DO IT...*

## Catalogue for Stringing Tools

### **Introduction:**

Our company was established in year 2009 we have completed various projects with many reputed companies which include custom project fabrication.

We have team of qualified technical personals. Who have helped us to carve a niche for ourselves in the field. We have a view to fill up the void created by a crisis of contractors with professionals who would support the clients in their infrastructural and turnkey projects in a better way. Our team members have an in-depth knowledge of the matter and put their heart and soul into the projects to deliver the best service. Many of clients being satisfied with our Work.

# About us

We @**PRRAY FAB INDUSTRIES** manufacturers of high quality of Stringing & Erection Tools. We maintain a superior level of integrity in interactions with business partners and associates and we conduct our business as a Model Corporate Citizens.

Our **MISSION** is to manufacture the improved quality of stringing and erection tools utilizing quality practice and latest technology involvement, we also wish to produce and invent the new tools may be suitable for some activities during Stringing and Erection activity.

Our **VISION** is to continuously work towards improving our Processes of manufacturing, Products and after sale services that not only satisfy the Customer's Needs but also surpasses the Customers Expectations of Quality, Safety and Reliability

Our **TEAM** comprises of Senior Engineers, Mechanical Engineers from Transmission Lines Industry who are well knowledgeable in Machine Operating. We have a strong R & D Team that includes trained engineers and people who have more than 10 years of experience in the Transmission Lines industry. These people are capable of producing not only world class products but are also technically sound to create special solutions for engineering needs of the T&D Industry. We have testing facilities at our plants that is equipped with various testing machines like load testing, material testing machines etc.

We are **MANUFACTURING** Single sheave pulley, double sheave pulley, four sheave pulley, equalizer pulley, drum jack, turn buckle, automatic clamp, come along clamp, Arial roller, pilot wire drum, compressor joint machine, double caption winch machine, hydraulic winch machine, hydraulic conductor cutter, all type of stringing tools accessories and many other products also.

<b>Name Of the Organization</b>	<b>PRRAY FAB INDUSTRIES</b>
<b>Type of Supplier</b>	Manufacturer
<b>Year Of Establishment</b>	2017
<b>Address</b>	<p><b><u>Office</u></b>                      B – 1, SHREE HARI ARCADE,                      VILLAGE : BAKROL BUJRANG,                      TA. DASKOI,                      Ahmedabad-382430</p> <p><b><u>Unit-1</u></b>                      B – 1. SHREE HARI ARCADE,                      VILLAGE : BAKROL BUJRANG,                      TA. DASKOI,                      AHMEDABAD-382430</p>
<b>Contact Persons ( Head Office )</b>	Mr. PANKAJJ PATEL - +91 9512166119 EMAIL ID: - prrayfab@gmail.com
<b>Factory Area</b>	<b>UNIT-1 - TOTAL PLOT AREA - 1400 SQ. YARD</b> <b>UNIT-2 - TOTAL PLOT AREA - 520 SQ. YARD</b>
<b>Bank Details</b>	Name: UCO BANK Branch: ODHAV Ahmedabad. Account Type: Current A/C Account No: 33790210001509 IFSC RTGS Code: UCBA0003379 Contact Person: Mr. PANKAJJ PATEL
<b>Registration Details:</b>	GST TIN No – 24ASCPP6312N2ZK PAN No – ASCPP6312N
<b>Range of Product</b>	1. Storage tank – capacity up to 85,000 ltrs 2. Storage tank – Capacity 5 mtrs Dia. 3. All type of stringing tools for TNP Line 4. Specialist SPM machine 5. Precision job work
<b>Production Capacity (In Year)</b>	700 tons

<p><b>Details of Employees</b></p>	<ul style="list-style-type: none"> <li>• Total Number of employees : 41 Person</li> <li>• Engineer/ Supervisor : 09</li> <li>• Turner : 03</li> <li>• Fitter : 04</li> <li>• Qualified Arc/ MIG welder : 04</li> <li>• Qualified TIG Welder : 02</li> <li>• Casual Welder : 03</li> <li>• Drawing fitter : 05</li> <li>• Riggers : 05</li> <li>• Casual workers : 06</li> </ul>
<p><b>Services</b></p>	<ol style="list-style-type: none"> <li>1. Equipment Fabrication like Transformer tanks like 5 MVA to 60 MVA, Heat Exchanger, pr. vessels, tanks &amp; other Engg. Applications.</li> <li>2. Core channel of transformer fabrication.</li> <li>3. Shot Blasting &amp; Painting.</li> <li>4. Hot Dip Galvanizing &amp; Galvanizing Work for Structural &amp; other Engg. Applications.</li> <li>5. Operation &amp; Maintenance contracts of various types of industries.</li> </ol>
<p><b>Machinery Description</b></p>	<ol style="list-style-type: none"> <li>1. Laser Cutting Machine 3000W: 01 No.</li> <li>2. Over Head Crane With electrically operated hoist 5Tons Capacity: 01 No.</li> <li>3. MIG machine 400 Amp: 04 Nos.</li> <li>4. ARC + TIG Machine 400 Amp: 02 Nos.</li> <li>5. Arc Machine 400 Amp: 02 Nos.</li> <li>6. Arc Machine 200 Amp: 02 Nos</li> <li>7. Pillar Drill 42 MM Dia Capacity: 01 No.</li> <li>8. Magnet Drill 31 MM Dia Capacity: 01 No.</li> <li>9. Tools &amp; Tackles Set: 01 No.</li> <li>10. Hand Cutter 14": 04 No.</li> <li>11. Hand Grinder 4": 10 No.</li> <li>12. Hand Grinder 7": 03 No.</li> <li>13. Chain Block Pulley 5 Ton with 30 Ft Ht working cap: 04 No.</li> <li>14. Gas Cutting set with cutting torch &amp; 15 Mtrs Long hose: 03 No.</li> <li>15. PUG Cutting Set: 02 Nos.</li> </ol>

	<p>16. Compressor 500 Ltrs with painting gun: 04 No.          17. CNC Bending Machine          18. CNC Turning Center 3nos.          19. VMC Machine 2nos          20. Bandsaw Machine 1nos</p>
<p><b>Clients</b></p>	<ul style="list-style-type: none"> <li>• KALPTARU POWER TRANSMISSION</li> <li>• ADVAIT INFRATECH Pvt. Ltd</li> <li>• POWERLITE, NARODA, AHMEDABAD</li> <li>• TATA PROJECT LIMITED (TPL)</li> <li>• WADIA BODY BUILDERS</li> <li>• TATA PROJECTS LTD.</li> <li>• MAMTA MACHINERY MFG.CO PVT</li> <li>• GABBAR ENGINEERING CO.</li> <li>• GINZA MACHINERY CO.</li> <li>• CAREFOAM INDUSTRIES</li> <li>• ATS LIMITED</li> </ul>

## Motorized Compressor Machine

Hydraulic Press of 100 Ton, 125 Ton, 150 Ton Compressive Capacity for compression of Joints on Conductor and Steel Rope for High Voltage Electric Line. The Power generated by Gasoline Engine.

### Technical Details

- ▶ Equipped with quick release couplings
- ▶ Engine: Four stroke petrol engine Honda GX200, 5.5 HP
- ▶ Flow 1.4 L/Min
- ▶ Max Oil pressure 700 bar
- ▶ Oil Tank capacity 20 lt.
- ▶ Weight: 69 Kg
- ▶ Size: 63 x 48 x 50 cm



## Manual Drum Lifting Jack

### Technical Details

- ▶ Suitable for paying out cables during stringing conductor's operations
- ▶ Reel lifting by Manual Jack Hand Operated Gear Mechanism.
- ▶ The frame is completely detachable to reduce dimensions during transport.
- ▶ Mechanical disk braking system to control the drum when unwinding the conductor.



## Turn Table

### Technical Details

- ▶ Made of Mild Steel
- ▶ Suitable for Reel Dia. 1800 - 2400 mm
- ▶ With Breaking arrangement
- ▶ Weight Kg. 185
- ▶ Available in 3 Ton & 8 Ton for Earth Wire



## Single Sheave Close Pulley



### Technical Details

- ▶ Frame are made of MS and cover with paint g Suitable for steel rope.
- ▶ The wheels are mounted on ball bearings. Sheave diameter(mm) 150 mm.
- ▶ SWL: 10 Ton.
- ▶ Weight: 11 Kg.

## Two Sheave Pulley

### Technical Details

- ▶ Frame are made of MS and cover with paint
- ▶ Suitable for steel rope.
- ▶ The wheels are mounted on ball bearings.
- ▶ Sheave diameter(mm) 150 mm
- ▶ SWL- 5 Ton
- ▶ Weight- 14 Kg.





## Four Sheave Pulley

### Technical Details

- ▶ Heavy design for better protection of sheave
- ▶ Suitable for steel rope.
- ▶ The wheels are mounted on ball bearings.
- ▶ SWL- 10 Ton
- ▶ Weight- 23 Kg.

## Six Sheave Pulley

### Technical Details

- ▶ Heavy design for better protection of sheave
- ▶ Suitable for steel rope.
- ▶ The wheels are mounted on ball bearings.
- ▶ SWL- 10 Ton
- ▶ Weight- 28 Kg.



## Joint Protector For Conductor

### Technical Details

- ▶ Made of heavy-duty steel lube
- ▶ Both side rubber brushes to avoid damage of conductor.
- ▶ Specifically designed to protect the mid span
- ▶ Joint made at the tensioner station.

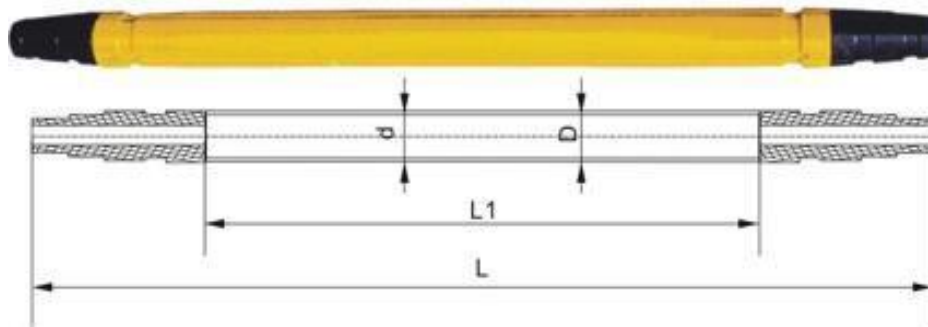

## Turn Buckle

### Technical Details

- ▶ Turn Buckle is used to anchor/tight various accessories ,conductor and equipment during stringing operation/ after end of stringing section
- ▶ Made of Galvanized Steel
- ▶ Available indual hook , dual eyeandeye-hook configuration
- ▶ SWL: Available in 5 Ton & 10 Ton
- ▶ Weight: 9kg & 16 kg



## Single/double End Sock Joint For Conductor

The Head type temporary mesh sock joints are specifically designed to temporarily connect the aluminum, steel or copper conductor to the pulling rope. They consist of variable pitch steel wires, which effectively distribute the gripping effect on the conductor.



## Three Bolt Come Along Clamp / Seven Bolt Come Along Clamp

### Technical Details

- ▶ Body: Made of steel in two parts.
- ▶ Sleeve: Alloy Aluminum Liners Provided to Grip Conductor
- ▶ Hook and eye bolts made of carbon steel.
- ▶ SWL: 2 Ton / 10 Ton.
- ▶ Weight: 11 / 17 Kg

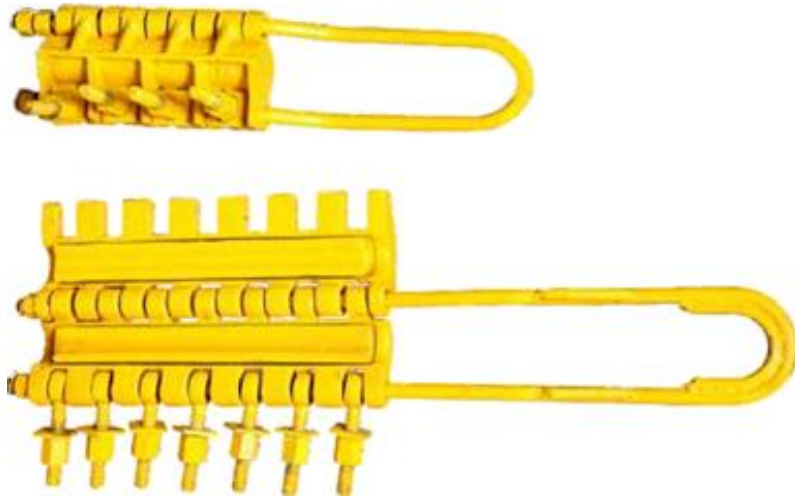

## Kitto Clamp

### Technical Details

- ▶ Material: Mild Steel
- ▶ Pin: EN8
- ▶ Suitable for 8mm to 12mm wire rope.
- ▶ Coating: Epoxy primer and thereafter enamel painted.
- ▶ Weight: 3.5 Kg



## Patta Clamp For Earth Wire.

### Technical Details

- ▶ Available for different Earth wire.
- ▶ The Frame are made of Mild Steel.
- ▶ Rusting Protecting: Primer thereafter enamel painted.
- ▶ Safe Working load: 5 Ton.



## Equalizer Pulley



To erect pole, line construction Work, hoist devices etc. Heavy duty snatch blocks, steel sheave mounted on Gun metal bush and painted frame. Suitable for steel wire rope.

### Technical Details

- ▶ Material: Mild steel
- ▶ OD: 300mm, Groove width (inner) : 28mm
- ▶ Groove Depth: 30mm
- ▶ SWL: 10 Ton
- ▶ Weight: 18 Kg
- ▶ Shafts: Made of EN-8 Steel of 36mm Dia.
- ▶ Bush material: Made of Gun metal
- ▶ Hooks: Made of EN-8 Forged Material I type.
- ▶ Rusting Protection: Primer Thereafter enamel painted.

## Single Sheave Aerial Roller 300mm/400mm



**Technical Details**

- ▶ Frame: Mild steel
- ▶ Motion: Ball Bearing.
- ▶ Coating: Epoxy Primer and thereafter enamel painted.
- ▶ Sheave Dimension (Outside Diameter x root diameter x sheave width) 300 x 236 x 65mm
- ▶ Safe working load: 2.5 Ton
- ▶ Weight: 10 Kg



**Manual Sag Winch**

**Technical Details**

- ▶ Body Made of steel
- ▶ Helical gears duly tempered
- ▶ Rotated on thrust bearings
- ▶ Pully suitable for 8-12 mm rope
- ▶ 2 speed arrangement
- ▶ Extra accessories for tower fixing provided.
- ▶ Working load 10 Ton



## Swivel or Articulated Joint



### Technical Details

- ▶ Material: high Tensile steel.
- ▶ Heat Treatment: Heating in Furnace Quenched in oil and Stress Relieved by tempering.
- ▶ Coating: Zinc
- ▶ SWL: 1.6 Ton / 5 Ton / 10 Ton / 25 Ton Available.

## S Type Roller

The rollers are made up of aluminum alloy & grooves are lined with neoprene rubber flap. The roller rolls on ball bearing. The frames are fabricated from alloy steel.

### Technical Details

- ▶ Frame: Mild Steel
- ▶ Motion: Ball Bearing.
- ▶ Coating: Epoxy Primer and thereafter enamel painted.
- ▶ Sheave Dimension (Outside Diameter x root diameter x sheave width) 300 x 236 x 65mm
- ▶ Safe working load: 2.5 Ton
- ▶ Weight: 10 Kg





### Hanging Pulley

Cable replacer are used where ever existing GW is required to replace by OPGW. The frame is fabricated from alloy steel while the rollers are made up of nylon. The rollers roll on ball bearings.

### Tandom type Roller

These rollers are used during stringing of single conductor, OPGV and sometimes used as a marking roller. The frames are made up of alloy steel while rollers are made up of nylon.



### Bull Dog Clamp



### D Shackle



## Automatic Clamp For Conductor

The design of the clamp is simple and operation is easy with positive grip on conductor. The body of the clamp is fabricated from high tensile steel. Aluminum liner sleeve are provided within the clamp to avoid damage to the conductor during operation. Pins provided are of EN8 forged steel.

### Technical Details

- ▶ Maximum safety load 5 Ton, weight 16 Kg
- ▶ No slipping of wire for highest pulling forces



## Ground Roller

The barrels are made up of rubber molding and rolls on ball bearing while the stands are fabricated From alloy steel tubes and flats.

## Pilot Wire Connector

### Technical Details

- ▶ Made of High Tensile Galvanized steel.
- ▶ Suitable for connecting two pilot wire lengths together
- ▶ Supplied with cover roller / sleeve to avoid sharp bending of pilot Eye.

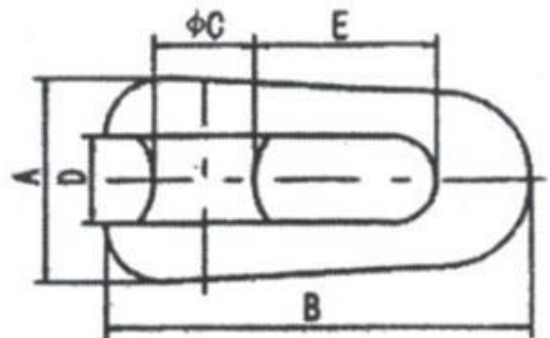

Dimension: A,B,C,D,E

## Sag Plate

### Technical Details

- ▶ Body: The frame is made of Mild Steel
- ▶ Rusting protection: primer thereafter enamel painted.
- ▶ Safe Working load: 5 Ton
- ▶ Weight: 18 Kg



## CRADLE REEL STAND FOR PILOT WIRE REEL



The reel stand is made of welded steel pipes and used to support & lift the Pilot Reel and provide required ground clearance during payout operation. Supplied with shaft, bracket support and one side brake

## EMPTY STEEL REEL

The reel is made of welded iron sections with protective paint or coating to prevent rusting. The reel is supplied with two no. of Cross Plates on each side. Used to wind and unwind the pilot wire in case of any damage to original reel on which Pilot is winded and supplied.



# POWER WINCH MACHINE

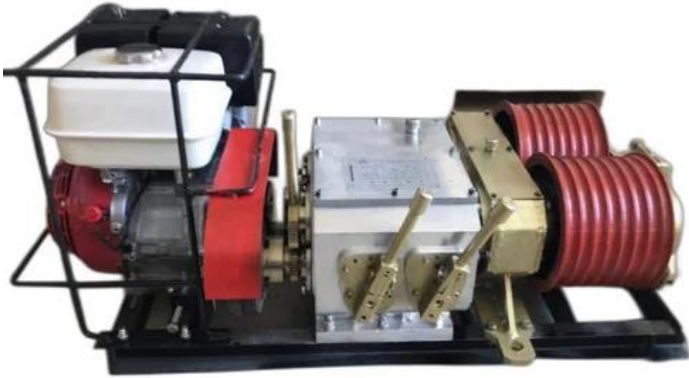

# PRRAY FAB

INDUSTRIES

Office Address

B – 1 , SHREE HARI ARCADE,  
VILLAGE : BAKROL BUJRANG,  
TA. DASKOI,  
Ahmedabad-380026.  
Gujarat.

Workshop Address

B – 1 , SHREE HARI ARCADE,  
VILLAGE : BAKROL BUJRANG,  
TA. DASKOI,  
BAKROL, Ahmedabad-382210.  
Gujarat.

Email Id:

[prrayfab@gmail.com](mailto:prrayfab@gmail.com)

Contact No.

Mr. PANKAJJ PATEL : +91-9512166119,9033281090

